

A Better Kitchen. A Better Way.



cardell
CABINETRY®



The Cardell® Cabinetry Difference.

Cardell is an easier way. It's the way to find the vanity you're looking for. With timeless and popular styles, practical features like drawers that don't slam, and a simple ordering process, Cardell is a better way to get the kitchen you want.



Quality

With excellent warranties and proven product strength, you can have confidence that your vanity will stand up to daily life.



Speed

Our process is designed to be swift. Easy selection. Efficient ordering. Shipping in 21 days or less.



Simplicity

We've built a better process. Simple step by step ordering. Ordering tools online and in-store. Choices that are clear. Price ranges that are transparent.



Empowerment

Cardell puts the power of the vanity-buying process back into your hands. We've stripped away the hassle, providing you with the choices, the speed, and the service you should expect from a cabinet company.



Cardell.com



View Our Entire Selection

Online

homedepot.com/cardell

Cover:
Door Style: Rafina
Finish: Natural
Wood Type: Maple

Beautiful. Simplicity.

**LIFETIME
LIMITED
WARRANTY**

Visit Cardell.com
for warranty details.



Door Style: Torvin
Finish: Coffee
Wood Type: Oak



Door Style: Atle
Finish: Honey
Wood Type: Cherry



Door Style: Casoria
Finish: Ebon Smoke
Wood Type: Maple



Door Style: Casoria
Finish: Linen with Tuscan Glaze
Wood Type: Maple



Door Style: Casoria
Finish: Linen with Tuscan Glaze
Wood Type: Maple

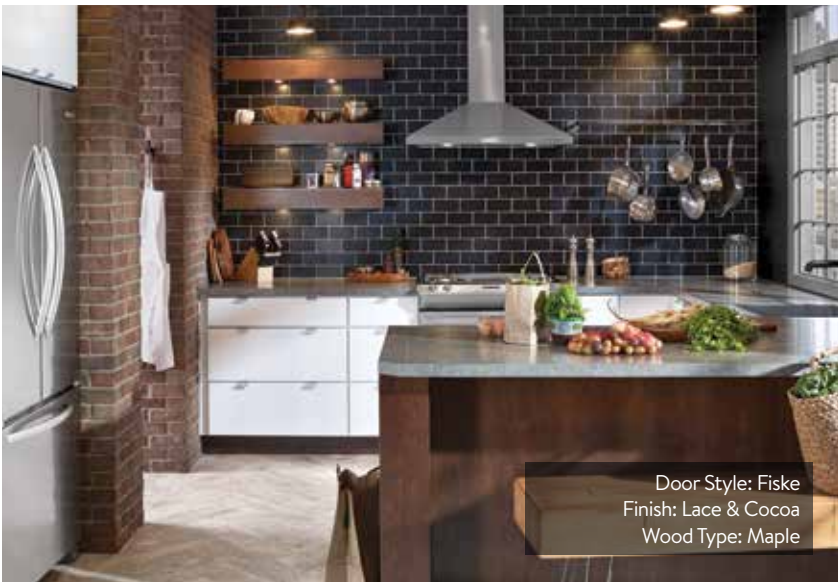

Door Style: Fiske
Finish: Lace & Cocoa
Wood Type: Maple



Door Style: Fiske
Finish: Lace & Cocoa
Wood Type: Maple

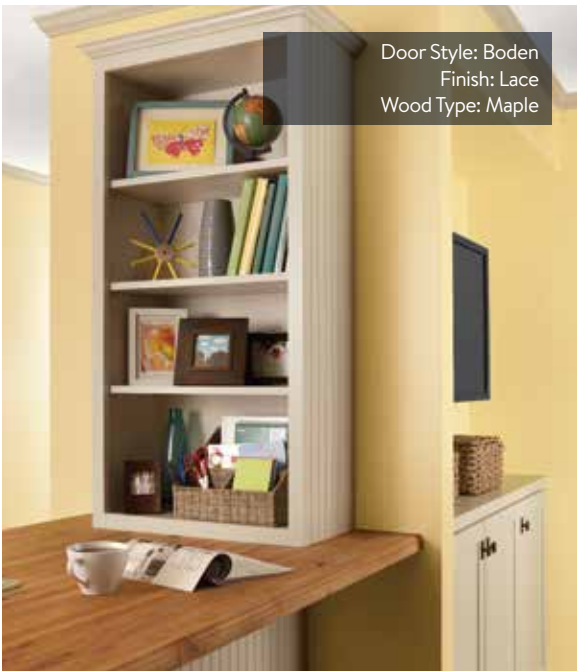

Door Style: Boden
Finish: Lace
Wood Type: Maple



Door Style: Boden
Finish: Lace
Wood Type: Maple



Door Style: Farila
Finish: Cocoa & Lace with Tuscan Glaze (island)
Wood Type: Cherry & Maple (island)



Door Style: Farila
Finish: Cocoa & Lace with Tuscan Glaze (island)
Wood Type: Cherry & Maple (island)



Door Style: Farila
Finish: Cocoa
Wood Type: Cherry



Door Style: Galway
Finish: Caramel w/ Java Glaze
Wood Type: Maple



Door Style: Galway
Finish: Caramel w/ Java Glaze
Wood Type: Maple



Door Style: Boden
Finish: Lace
Wood Type: Maple



Door Style: Farila
Finish: Cocoa
Wood Type: Cherry



Door Style: Rafina
Finish: Natural
Wood Type: Maple



Door Style: Atle
Finish: Honey
Wood Type: Cherry



Door Style: Casoria
Finish: Ebon Smoke
Wood Type: Maple

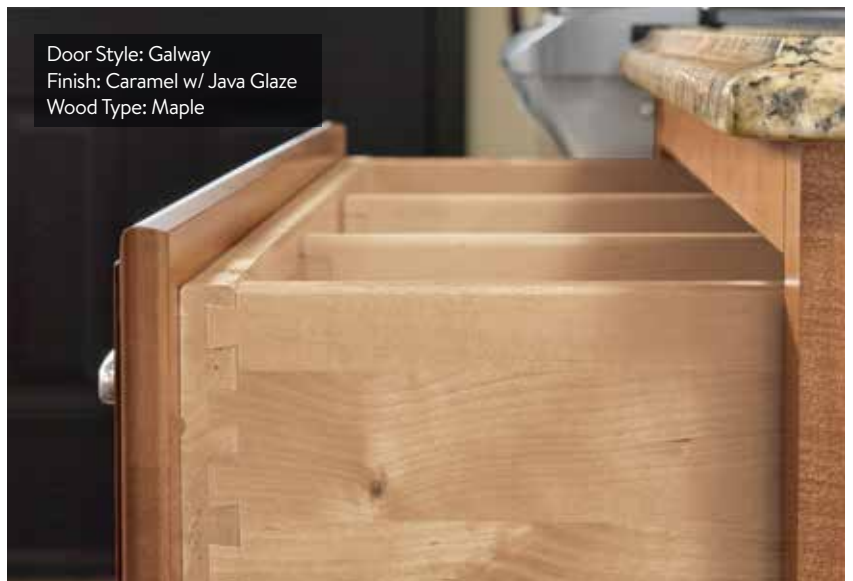

Door Style: Galway
Finish: Caramel w/ Java Glaze
Wood Type: Maple



Door Style: Galway
Finish: Caramel w/ Java Glaze
Wood Type: Maple



Door Style: Boden
Finish: Lace
Wood Type: Maple



Door Style: Atle
Finish: Honey
Wood Type: Cherry



Door Style: Fiske
Finish: Lace & Cocoa
Wood Type: Maple



Door Style: Fiske
Finish: Lace & Cocoa
Wood Type: Maple

DOOR STYLES



Atle
Wood Types: Maple, Cherry
Overlay: Full
Center Panel: Recessed Veneer
Door Shape: Square
Drawer Front: 5-pc



Bardson
Wood Types: Maple, Cherry
Overlay: Full
Center Panel: Recessed Veneer
Door Shape: Square
Drawer Front: 5-pc



Boden
Wood Types: Maple, Cherry
Overlay: Full
Center Panel: Recessed Veneer
Door Shape: Square
Drawer Front: 5-pc



Casoria
Wood Types: Maple, Cherry
Overlay: Full
Center Panel: Recessed Veneer
Door Shape: Square
Drawer Front: 5-pc



Farila
Wood Types: Maple, Cherry
Overlay: Full
Center Panel: Raised Veneer
Door Shape: Square
Drawer Front: Slab



Fiske
Wood Types: Maple, Cherry
Overlay: Full
Center Panel: Slab Veneer
Door Shape: Square
Drawer Front: Slab



Galway
Wood Types: Maple, Cherry, Oak
Overlay: Partial
Center Panel: Recessed Veneer
Door Shape: Square
Drawer Front: Slab



Larus
Wood Types: Maple, Cherry
Overlay: Full
Center Panel: Raised Solid Wood
Door Shape: Square
Drawer Front: 5-pc



Pallini
Wood Types: Maple, Cherry, Oak
Overlay: Full
Center Panel: Recessed Veneer
Door Shape: Square
Drawer Front: Slab



Pallini
Wood Types: Maple, Cherry, Oak
Overlay: Full
Center Panel: Recessed Veneer
Door Shape: Square
Drawer Front: 5-pc



Rafina
Wood Types: Maple, Cherry
Overlay: Full
Center Panel: Recessed Veneer
Door Shape: Square
Drawer Front: Slab



Rafina
Wood Types: Maple, Cherry
Overlay: Full
Center Panel: Recessed Veneer
Door Shape: Square
Drawer Front: 5-pc

DOOR STYLES



Salvo
Wood Types: Maple, Cherry, Oak
Overlay: Partial
Center Panel: Raised Veneer
Door Shape: Square
Drawer Front: Slab



Salvo
Wood Types: Maple, Cherry, Oak
Overlay: Partial
Center Panel: Raised Veneer
Door Shape: Arch (wall or tall cabinets only)
Drawer Front: None



Serrano
Wood Types: Maple, Cherry
Overlay: Full
Center Panel: Raised Solid Wood
Door Shape: Square
Drawer Front: Slab



Serrano
Wood Types: Maple, Cherry
Overlay: Full
Center Panel: Raised Solid Wood
Door Shape: Arch (wall or tall cabinets only)
Drawer Front: None



Sevran

Wood Types: Maple, Cherry, Oak, Hickory
Overlay: Partial
Center Panel: Raised Solid Wood
Door Shape: Square
Drawer Front: Slab



Sevran

Wood Types: Maple, Cherry, Oak, Hickory
Overlay: Partial
Center Panel: Raised Solid Wood
Door Shape: Arch (wall or tall cabinets only)
Drawer Front: None



Stig

Wood Types: Maple, Cherry, Oak
Overlay: Partial
Center Panel: Recessed Veneer
Door Shape: Square
Drawer Front: Slab



Torvin

Wood Types: Maple, Cherry, Oak
Overlay: Full
Center Panel: Recessed Veneer
Door Shape: Square
Drawer Front: Slab

DOOR STYLES



Arbon
Wood Types: Thermofoil
Overlay: Partial
Center Panel: Raised
Door Shape: Square
Drawer Front: Thermofoil



Westby
Wood Types: Thermofoil
Overlay: Full
Center Panel: Raised
Door Shape: Square
Drawer Front: Thermofoil

GLASS INSERTS



Square Mullion Glass



Arch Mullion Glass



Bistro Glass



Savannah Mullion Glass



CONSTRUCTION

Like you, cabinets live in your home. They experience the daily wear and tear of use and life. To ensure your cabinets are up to the challenge, we've built Cardell cabinets to last. They meet and surpass industry standards and are backed by an impressive warranty.



Wall Cabinet.

Durable construction.

Built to work and last. $\frac{3}{8}$ " thick end panels attached with wood-to-wood glue and staples.

Meets or exceeds KCMA standards.

We have our own testing facilities to make certain our cabinets meet or exceed the standards set by the Kitchen Cabinet Manufacturers Association (KCMA).



Base Cabinet.

Finished look.

With $\frac{3}{8}$ " thick, industrial-grade, engineered wood end panels.

Strong shelves.

Made from $\frac{3}{4}$ " thick engineered wood.

Lifetime limited warranty.

For more information, visit Cardell.com.

FINISHES

Maple Stain



Stain: Natural



Stain: Caramel



Stain: Nutmeg



Stain: Sedona



Stain: Cocoa



Stain: Coffee



Stain: Ebon Smoke

Stain Process

Stain is applied and brush-wiped to desired color. Next, sealer is applied to protect the finish and prevent warping and cracking of the hardwood. Sealer is then sanded to develop a bonding surface for the topcoating process. As a final step, a heat activated topcoat is applied to provide a beautiful and durable furniture finish. Finish availability may vary by door style. Consult with your Cardell® Cabinetry designer.

Maple Stain w/ Glaze



Stain w/ Glaze:
Natural w/ Java Glaze



Stain w/ Glaze:
Caramel w/ Java Glaze



Stain w/ Glaze:
Nutmeg w/ Ebony Glaze

Maple Paint

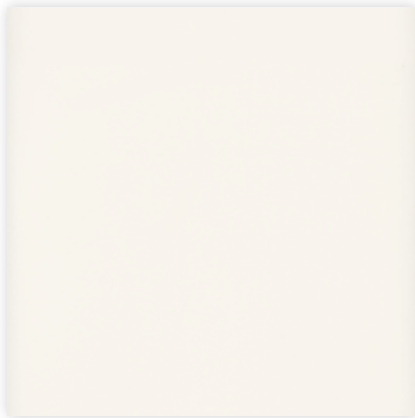

Paint: Lace

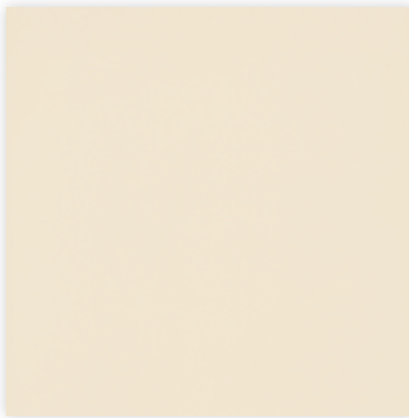

Paint: Linen



Paint: Cobblestone

Paint Process

Our painted finishes consist of several coats of pigmented semi-opaque enamel paint that are allowed to saturate the hardwood, developing richness while allowing some of the natural grain to remain visible. As a final step, a heat activated topcoat is applied to provide a beautiful and durable furniture finish. Finish availability varies by door style. Consult with your Cardell® Cabinetry designer.

FINISHES

Paint w/ Glaze



Paint w/ Glaze:
Lace w/ Tuscan Glaze



Paint w/ Glaze:
Linen w/ Tuscan Glaze



Paint w/ Glaze:
Linen w/ Desert Glaze

Paint w/ Traditional Glaze Process

Several coats of pigmented semi-opaque enamel paint are applied and allowed to saturate the hardwood developing richness while allowing some of the natural grain to remain visible. Next, sealer is applied to protect the finish and prevent warping and cracking of the hardwood. Sealer is then sanded to develop a bonding surface for the glazing and topcoat process. Glaze is applied, face side only, to corner hang-ups and profile recesses depending on door style. As a final step, a heat activated topcoat is applied to provide a beautiful and durable furniture finish. Finish availability varies by door style. Consult with your Cardell® Cabinetry designer.

Cherry Stain



Stain: Cocoa



Stain: Honey

Cherry Stain w/ Glaze



Stain w/ Glaze:
Honey w/ Java Glaze

Stain w/ Traditional Glaze Process

Stain is applied and brush-wiped to desired color. Next, sealer is applied to protect the finish and prevent warping and cracking of the hardwood. Sealer is then sanded to develop a bonding surface for the glazing and topcoat process. Glaze is applied by hand (face side only) to corner hang-ups and profile recesses depending on door style. As a final step, a heat activated topcoat is applied to provide a beautiful and durable furniture finish. Finish availability varies by door style. Consult with your Cardell® Cabinetry designer.

FINISHES

Oak Stain



Stain: Natural



Stain: Honey



Stain: Cocoa



Stain: Coffee

Hickory Stain



Stain: Natural

Thermofoil

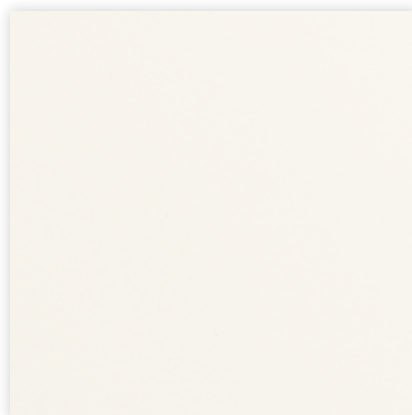

Thermofoil: White

HARDWARE

Satin Nickel



Black Nickel

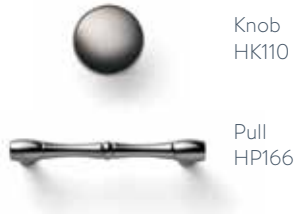

Brushed Satin Pewter



Antique Pewter

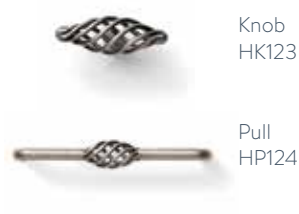

Copper Pewter



Antique Iron

Satin Aluminum

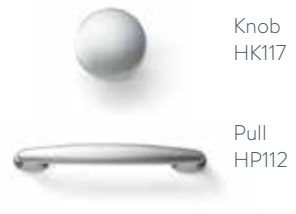

Bright Chrome



Brass

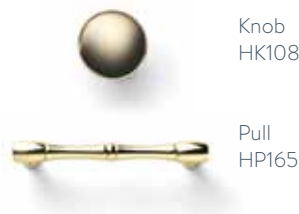

White

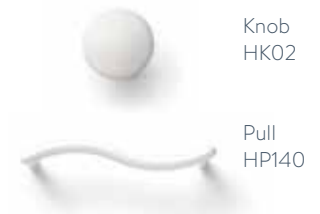

Black



Oil Rubbed Bronze



Venetian Bronze



Ochre



Gunmetal



Rusty



Dusty Copper



Antique Pewter



cardell[®]
C A B I N E T R Y

Cardell.com

Actual colors may vary slightly due to printing limitations. For full color accuracy, please visit The Home Depot.
©2015 Masco Cabinetry LLC. Printed in the USA. 08/15